



ASSEMBLY INSTRUCTIONS INSTRUCCIONES DE ENSAMBLE

MADEIRA TABLE / RECTANGULAR MESA MADEIRA / RECTANGULAR



/ Assembly Parts / Piezas de Ensamble



X4

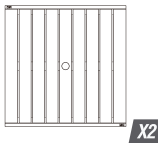

X2



X1

Bristle screw
Tornillos cabeza bristle

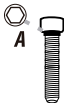

X12



X12



X12



X2

33 Cross Screws
Tornillos de estrella



X4



X8



X2

Double hex key
Llave hexagonal doble



X1



X1

Place side by side the table ends with perforations
Enfrentar los extremos de la mesa con perforaciones

1

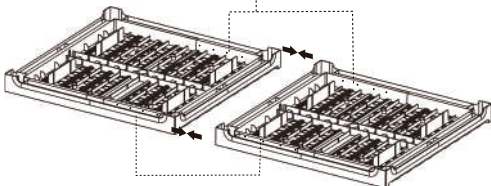

x2 Repeat this step with both metal plates and joints
Repita este paso con las dos platinas metálicas y uniones

2

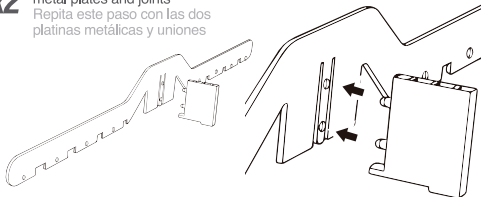

Be sure to align the metal plates with covers and holes on the sides of the pieces for later screw installation.

Asegure de alinear las platinas metálicas con las cubiertas y los orificios en los laterales de la misma para posteriormente instalar los tornillos.

3

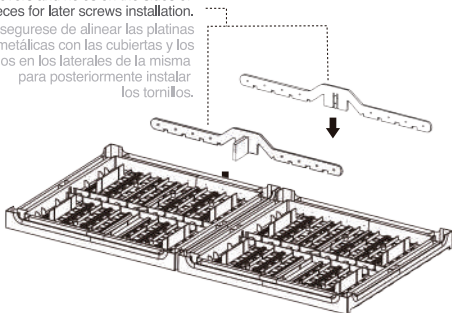

4

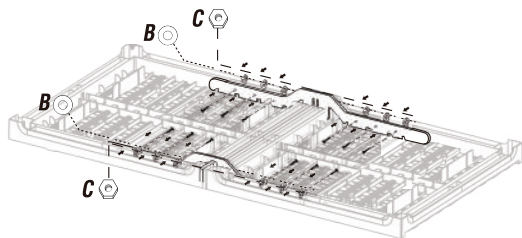

Secure the screws with
the included tools
Utilice la herramienta incluida
para asegurar los tornillos



5

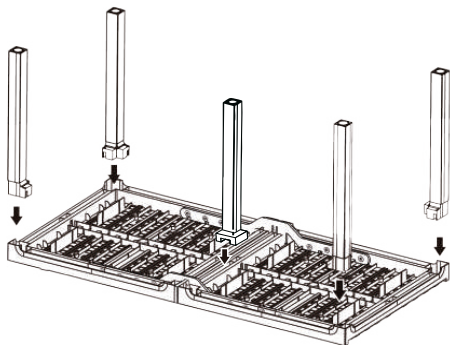

6

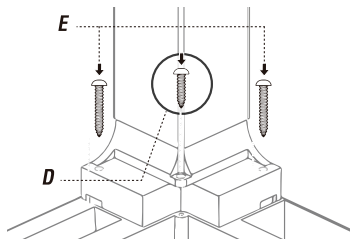

▶ **VIEW ASSEMBLY VIDEO** | **VER VIDEO DE ENSAMBLE**



LINE LINEA
MADEIRA

IMPORTANT: Please contact Customer Service if you have any problems or discover any missing parts.
IMPORTANTE: Sírvase contactar con nuestro Servicio al Cliente por cualquier problema o pieza que pudiera faltar. www.plasticosmq.com.co